

NA



FILE



GROUND WATER CERTIFICATE



*76N *



30106445

Current File Location: **RECORDS UNIT**

As of :

Status:

Box Bar Code:

File Bar Code:

5/25/2016

STATE OF MONTANA
DEPARTMENT OF NATURAL RESOURCES AND CONSERVATION
1424 9TH AVENUE P.O.BOX 201601 HELENA, MONTANA 59620-1601

CERTIFICATE OF WATER RIGHT

UPON FINDING THE REQUIREMENTS OF SECTION 85-2-306, MCA, HAVE BEEN MET, THIS CERTIFICATE OF WATER RIGHT IS GRANTED.

Water Right Number: 76N 30106445 GROUND WATER CERTIFICATE
Version: 1 -- ORIGINAL RIGHT
Version Status: ACTIVE

Owners: GRACE SANDPOINT INC
PO BOX 1121
SANDPOINT, ID 83864
Priority Date: APRIL 26, 2016 at 08:30 A.M.
Enforceable Priority Date: APRIL 26, 2016 at 08:30 A.M.

Purpose (use): FISHERY
Maximum Flow Rate: 10.00 GPM
Maximum Volume: 2.02 AC-FT
Source Name: GROUNDWATER
Source Type: GROUNDWATER

Point of Diversion and Means of Diversion:

ID	Govt Lot	Qtr Sec	Sec	Twp	Rge	County
1		NENENE	17	27N	34W	SANDERS

Period of Diversion: JANUARY 1 TO DECEMBER 31

Source Name: GROUNDWATER
Diversion Means: DEVELOPED SPRING

Purpose (Use): FISHERY
Volume: 2.02 AC-FT
Period of Use: JANUARY 1 to DECEMBER 31
Place of Use:

ID	Acres	Govt Lot	Qtr Sec	Sec	Twp	Rge	County
1			NENENE	17	27N	34W	SANDERS

BACKFLOW PREVENTOR

PURSUANT TO SECTION 85-2-505, MCA, TO PREVENT GROUND WATER CONTAMINATION, AN OPERATIONAL BACKFLOW PREVENTOR MUST BE INSTALLED AND MAINTAINED BY THE APPROPRIATOR IF A CHEMICAL OR FERTILIZER DISTRIBUTION SYSTEM IS CONNECTED TO THE DIVERSION MEANS.

THIS CERTIFICATE IS SUBJECT TO ALL PRIOR EXISTING WATER RIGHTS IN THE SOURCE OF SUPPLY.

FAILURE TO COMPLY WITH ANY OF THESE TERMS AND CONDITIONS MAY RESULT IN THE LOSS OF THIS CERTIFICATE OF WATER RIGHT.

Witness Signature

Water Resources Division

DATE ISSUED: MAY 6, 2016

APR 26 2016

WORK COPY

Form No. 602 R 01/2016

NOTICE OF COMPLETION OF GROUNDWATER DEVELOPMENT

Use this form for completed groundwater developments where the water has been put to use for the purposes identified with a maximum use of 35 GPM not to exceed 10 AC-FT per year.

Incomplete forms will be returned.

Filing Fee \$125.00

Make checks payable to DNRC.

KALISPELL UNIT
FOR DEPARTMENT USE ONLY

Notice No. 30106445 Basin 76N
 Priority Date 4/26/16 Time 9:30 (AM) - PM
 Rec'd By MNS
 Fee Rec'd \$ 125.00 Check No. 1317
 Deposit Receipt # KFW1627695
 Payor (if different from name(s) listed in item 1 below) _____
 Refund \$ _____ Date _____
 Deficiency Letter Sent _____

- ⇒ Your priority is determined by the date of filing. If it is determined this form was improperly filed, your priority date may be changed.
- ⇒ If your development is within a Controlled Groundwater Area, this form cannot be used. Contact your Regional Office for more information.

1. **NAME(S)** Grace Sandpoint, Inc 332484
MAILING ADDRESS P.O. Box 1121
CITY Sandpoint **STATE** ID **ZIP** 83884
PHONE #: HOME _____ **WORK** 208-263-8900 **CELL** 208-360-7492
EMAIL ADDRESS gracesandpointworship@gmail.com "Trevor" ↑

2. HAS THIS WATER BEEN PUT TO USE FOR THE PURPOSES ON WHICH YOU ARE FILING?
 Yes No (IF YOU ANSWER NO, YOU CANNOT FILE THIS FORM AT THIS TIME.)

3. DIVERSION USED TO OBTAIN GROUNDWATER

- Well - Attach well log, if available. *Water Well Contractor Name:* _____
- Developed Spring (Excavation performed at the spring location)
- Pit/Pond - Surface Area 0.25 Acres # _____ Depth _____

per call w/ Trevor 4/27/16 MNS

4. FLOW RATE USED 10 GPM (Cannot Exceed 35 GPM)

5. COMBINATION OR SHARED DEVELOPMENT

a. Are there other groundwater developments on your property? Yes No
 If yes, how far away are the existing groundwater developments from this new groundwater development?
 Provide a DNRC water right number for each.

b. Is this development used for another water right or by another user? Yes No *per geocode and Trevor call MNS*
 If yes, please explain how and provide a DNRC water right number for each.

76N-124880-00 is the original domestic use water right on this property for a spring. A portion of this spring water is diverted to the pond which is the subject of this form.

6. PURPOSE AND PERIOD OF USE: Check those that apply and answer applicable questions

Domestic: Number of homes supplied: _____
 Year round use? Yes No If no, from _____ to _____, inclusive of each year.

Lawn & Garden: Include only watered area. Do not include house footprint, driveway, graveled areas, etc.
Total size of lawn & garden - length x width _____ -OR- Number of Acres _____
April 1 - October 31 Yes No If no, from _____ to _____, inclusive of each year.

Irrigation: (Do not include Lawn & Garden Irrigation)
Type of crop _____ Total Crop Acres Irrigated _____
April 1 - October 31 Yes No If no, from _____ to _____, inclusive of each year.

Stock:
Number & type: (Ex: 100 Cows & 1 Horse) _____
Year round use? Yes No If no, from _____ to _____, inclusive of each year.

Other: (Do not include purposes described above)
Describe the purpose of the use Reservoir, recreation and backup for domestic FISHING
Amount of water used ~~50~~ 98,000 CF gallons per day Number of days used ~~240~~ 365
Year round use? Yes No If no, from 01 Apr to 31 Oct, inclusive of each year.

88,000 CF =
2.02 AC/FT

7. **POINT OF DIVERSION** - Location of the groundwater development
NE NE NE
SE 1/4 SW 1/4 SW 1/4 of Section 9 17 Township 27 N S Range 34 E W
County Sanders Tract # _____ COS # _____ Gov't Lot # _____
Subdivision Name _____ Lot _____ Block _____
Street Address, including City/State/Zip Code 189 Blue Creek Road, Heron, MT 59844

8. **PLACE OF USE** - Enter the 17 digit geocode(s) applicable to the place of use legal land description.
Geocodes can be found in county records, tax statements, or at <http://svc.mt.gov/msl/mtcadastral/>.

Geocode: 35-3819-17-1-01-01-0000

IS THE PLACE WHERE WATER IS USED THE SAME AS THE POINT OF DIVERSION? Yes No

If no, enter the place of use land description below. Attach additional sheets if necessary.

____ 1/4 ____ 1/4 ____ 1/4 of Section ____ Township ____ N S Range ____ E W
County _____ Tract # _____ COS # _____ Gov't Lot # _____
Subdivision Name _____ Lot _____ Block _____
Street Address, including City/State/Zip Code _____

9. **AFFIDAVIT OF OWNERSHIP OR WRITTEN CONSENT**

I have possessory interest in the property where the water has been put to beneficial use and I have the exclusive property rights in the groundwater development works OR I have attached written consent of the person owning the groundwater development works and/or written notification to the land owner pursuant to MCA 85-2-306(1).

****Please note, you must submit ORIGINAL owner signatures, copies will not be accepted.****

I declare under penalty of perjury & under the laws of the State of Montana that the foregoing is true & correct.

Printed Name** Ben Ortice
Applicant Signature [Signature] PASTOR / PRESIDENT Date: 4/21/16
Printed Name** _____
Applicant Signature _____ Date: _____

Visit <http://dnrc.mt.gov/divisions/water> for additional water right related information.



APR 26 2016

KALISPELL UNIT

FOR DEPARTMENT USE ONLY

Form No. 602 R 01/2016

NOTICE OF COMPLETION OF GROUNDWATER DEVELOPMENT

Use this form for completed groundwater developments where the water has been put to use for the purposes identified with a maximum use of 35 GPM not to exceed 10 AC-FT per year.

Incomplete forms will be returned.

Filing Fee \$125.00

Make checks payable to DNRC.

Notice No. 30101445 Basin 76N
 Priority Date 4/26/16 Time 9:30 (AM) PM
 Rec'd By MMS
 Fee Rec'd \$ 125.00 Check No. 1317
 Deposit Receipt # KFW1627695
 Payor (if different from name(s) listed in item 1 below) _____
 Refund \$ _____ Date _____
 Deficiency Letter Sent _____

- ⇒ Your priority is determined by the date of filing. If it is determined this form was improperly filed, your priority date may be changed.
- ⇒ If your development is within a Controlled Groundwater Area, this form cannot be used. Contact your Regional Office for more information.

1. NAME(S) Grace Sandpoint, Inc 332484
MAILING ADDRESS P.O. Box 1121
CITY Sandpoint **STATE** ID **ZIP** 83884
PHONE #: HOME _____ **WORK** 208-263-8900 **CELL** 208-360-7492
EMAIL ADDRESS gracesandpointworship@gmail.com

2. HAS THIS WATER BEEN PUT TO USE FOR THE PURPOSES ON WHICH YOU ARE FILING?
 Yes No *(IF YOU ANSWER NO, YOU CANNOT FILE THIS FORM AT THIS TIME.)*

3. DIVERSION USED TO OBTAIN GROUNDWATER
 Well – Attach well log, if available. *Water Well Contractor Name:* _____
 Developed Spring (Excavation performed at the spring location)
 Pit/Pond – Surface Area 0.25 Acres ^{8'} Depth _____

4. FLOW RATE USED N/A GPM *(Cannot Exceed 35 GPM)*

5. COMBINATION OR SHARED DEVELOPMENT
 a. Are there other groundwater developments on your property? Yes No
If yes, how far away are the existing groundwater developments from this new groundwater development? Provide a DNRC water right number for each.

b. Is this development used for another water right or by another user? Yes No
If yes, please explain how and provide a DNRC water right number for each.

76N 124890-00 is the original domestic use water right on this property for a spring. A portion of this spring water is diverted to the pond which is the subject of this form.

6. PURPOSE AND PERIOD OF USE: Check those that apply and answer applicable questions

Domestic: Number of homes supplied: _____
 Year round use? Yes No If no, from _____ to _____, inclusive of each year.

Lawn & Garden: Include only watered area. Do not include house footprint, driveway, graveled areas, etc.
Total size of lawn & garden - length x width _____ -OR- Number of Acres _____
April 1 – October 31 Yes No If no, from _____ to _____, inclusive of each year.

Irrigation: (Do not include Lawn & Garden Irrigation)
Type of crop _____ Total Crop Acres Irrigated _____
April 1 – October 31 Yes No If no, from _____ to _____, inclusive of each year.

Stock:
Number & type: (Ex: 100 Cows & 1 Horse) _____
Year round use? Yes No If no, from _____ to _____, inclusive of each year.

Other: (Do not include purposes described above)
Describe the purpose of the use Reservoir, recreation and backup for domestic
Amount of water used 50 gallons per day Number of days used 210
Year round use? Yes No If no, from 01 Apr to 31 Oct, inclusive of each year.

7. **POINT OF DIVERSION** – Location of the groundwater development
SE 1/4 SW 1/4 SW 1/4 of Section 9 Township 27 N S Range 34 E W
County Sanders Tract # _____ COS # _____ Gov't Lot # _____
Subdivision Name _____ Lot _____ Block _____
Street Address, including City/State/Zip Code 189 Blue Creek Road, Heron, MT 59844

8. **PLACE OF USE** - Enter the 17 digit geocode(s) applicable to the place of use legal land description.
Geocodes can be found in county records, tax statements, or at <http://svc.mt.gov/msl/mtcadastral/>.
Geocode: 35-3819-17-1-01-01-0000

IS THE PLACE WHERE WATER IS USED THE SAME AS THE POINT OF DIVERSION? Yes No

If **no**, enter the place of use land description below. Attach additional sheets if necessary.

____ 1/4 ____ 1/4 ____ 1/4 of Section ____ Township ____ N S Range ____ E W
County _____ Tract # _____ COS # _____ Gov't Lot # _____
Subdivision Name _____ Lot _____ Block _____
Street Address, including City/State/Zip Code _____

9. **AFFIDAVIT OF OWNERSHIP OR WRITTEN CONSENT**

I have possessory interest in the property where the water has been put to beneficial use and I have the exclusive property rights in the groundwater development works OR I have attached written consent of the person owning the groundwater development works and/or written notification to the land owner pursuant to MCA 85-2-306(1).

****Please note, you must submit ORIGINAL owner signatures, copies will not be accepted.****

I declare under penalty of perjury & under the laws of the State of Montana that the foregoing is true & correct.

Printed Name** Ben Ortice

Applicant Signature [Signature] PASTOR / PRESIDENT Date: 4/21/16

Printed Name** _____

Applicant Signature _____ Date: _____



Visit <http://dnrc.mt.gov/divisions/water> for additional water right related information.

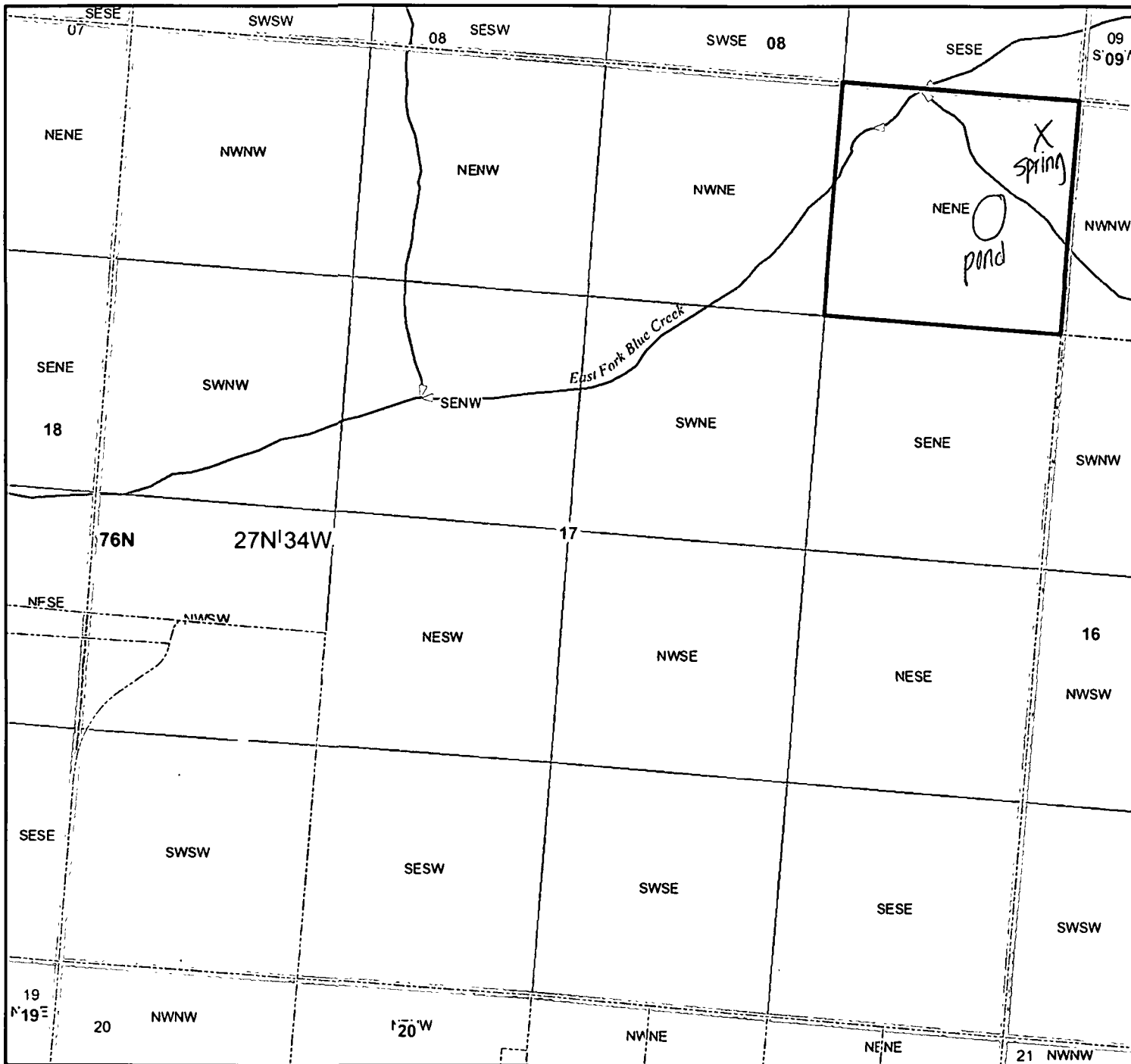

GRACE SANDPOINT INC NA 30106445 - 76N



Legend

-  Parcels
-  Section
-  Township & Range



N

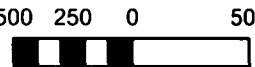

500 250 0 500 Feet

Location Map

