

Tennessee Department of Environment and Conservation - Division of Water Resources
Permit for Construction of a Subsurface Sewage Disposal System



Issued To: Cox, Derrick
 Location: 151 Windy Hill Pvt. Ln.
Butler, TN 37640
066 040.04

Inspector: Jackson Wise, ES2 
 Date: 03/28/2024

General Notes:
 - Please refer to the design specifications for the subsurface sewage disposal system on the first page of the construction permit.
 - Contact the local Division of Water Resources representative to schedule a final inspection.
 - All electric components (e.g., pump, alarm, etc.) for the subsurface sewage disposal system must be inspected and approved by the appropriate electrical inspector prior to requesting a final inspection. Documentation of the electrical inspection must be available during the final inspection.
CALL BEFORE 9 AM FOR INSPECTION 423-930-7854
INSTALL ON CONTOUR 6' BETWEEN TRENCHES
STAY 10' FROM PROPERTY LINES, WATER LINES, AND UTILITIES

750+ gallon tank
 220' total at 24-30" depth
 60 mpi

SEE ALL ATTACHMENTS

WITH PROPER PRODUCTS INSTALLED, A 30% REDUCTION MAY BE APPLIED

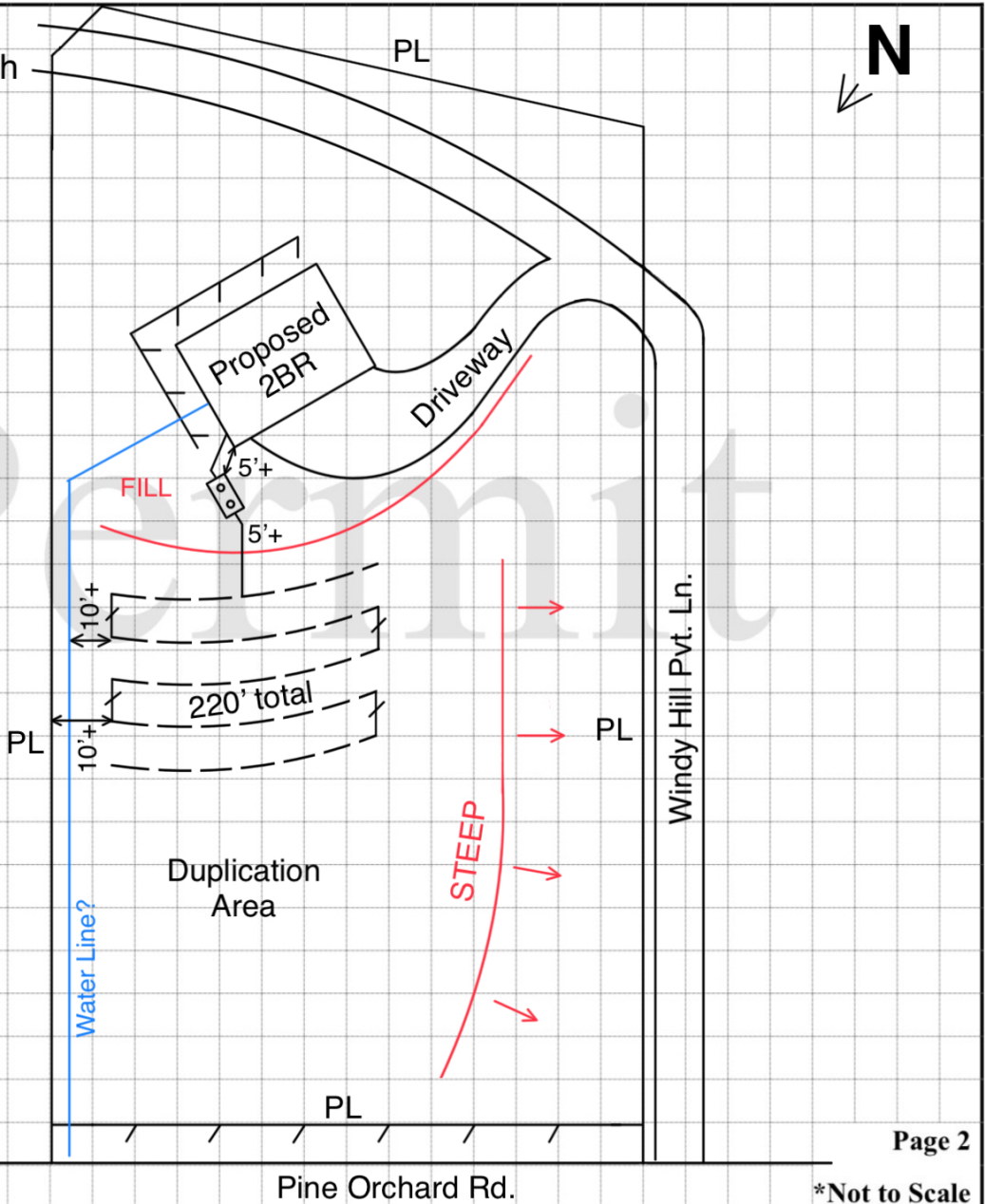



**TENNESSEE DEPARTMENT OF ENVIRONMENT AND CONSERVATION
DIVISION OF WATER RESOURCES
Land-Based Systems Unit
William R. Snodgrass – Tennessee Tower
312 Rosa L. Parks Ave., 11th Floor
Nashville, TN 37243-110**

**APPLICATION FOR WATER RESOURCES SERVICES
APPLICANT
COMPLETE QUESTIONS**

1. Service Requested (Check Service)	Fees Due
<input checked="" type="checkbox"/> Septic System Construction Permit	
<input checked="" type="checkbox"/> Dwelling	\$ 400.00 PAID
_____ Commercial: gdp	\$ _____
_____ System Modification	\$ _____
_____ Repair	\$ _____
<input checked="" type="checkbox"/> Conventional Construction Inspection	\$ 100.00 PAID
_____ Inspection Letter	\$ _____
_____ Certificate of Verification	\$ _____
_____ Water Sample	
_____ Total Coliform	\$ _____
_____ Fecal Coliform	\$ _____
_____ Alternative System Permit	\$ _____
_____ Alternative Construction Inspection	\$ _____
_____ Large Conventional System Plan Review	\$ _____
_____ Large Alternative System Plan Review	\$ _____
_____ Experimental System Plan Review	\$ _____
_____ Subdivision Evaluation: Lots: _____	\$ _____
_____ Pumping Contractor – Septage Application	\$ _____

2. LANDOWNER:

Names: Derrick Cox
 Address: 151 Windy Hill Private Lane
Butler, Tennessee 37640
 Day Phone: 4232177678
 Original Owner: _____

APPLICANT:

Names: Derrick Cox
 Address: 151 Windy Hill Private Lane
Butler, Tennessee 37640
 Day Phone: 4232177678
 Email: cxfamilyx5@gmail.com

Site Address:

Address: 151 Windy Hill Private Ln
Butler, Tennessee 37640

3. LOCATION OF LOT OR SITE:

a) Subdivision Name: _____ Lot # _____
 b) In a subdivision? No Give specific directions and address to the lot or site _____
 c) Tax Map 066 Parcel 040.04

FOR SSDS PERMIT

- 4. ONLY:**
- a) Size of lot 2.66 b) Number of Bedrooms 3 Bedrooms Added _____
 c) How many occupants? _____ d) Excavated Basement? Yes _____ No X
 e) Basement Plumbing Fixtures? Yes _____ No X
 f) Amount of water used monthly (gallons) _____
 g) Water Supply: Public X Well _____ Spring _____
 h) Is the lot staked? Yes _____ If not, date it will be staked: _____
 Is the house staked? yes If not, date it will be staked: _____
 i) Installer, if known: _____

5. FOR INSPECTION LETTER ONLY AND CERTIFICATE OF VERIFICATION ONLY:

- a) Age of house _____ b) Is house vacant? _____ How long? _____
 c) Original sewage system inspected _____
 d) Date of previous repairs _____ Inspected _____
 e) Is wastewater "backing up" into plumbing fixtures? _____ Surfacing on the ground? _____
 f) All wastewater including washing machines routed into septic tank _____

6. FOR WATER SAMPLE ONLY: a) Source of Supply: Spring _____ Well _____ Other _____

- b) Is there an outside faucet? _____ c) Is the source chlorinated? _____
 d) For Wells: Is the casing 6" above the ground? _____ Is a sanitary seal on the casing? _____

7. I certify that the above information is true and correct to the best of my knowledge; **I have been authorized by the above name landowner** to submit this application for Environmental Services to the Division of Water Resources.

DATE: Jul 31, 2023 SIGNATURE: Derrick Cox AMOUNT PAID: 500.00 RECEIPT NUMBER: 385553796

INSTALLATION NOTES:

- Call (423)854-5400 or the number on the permit between 8:00-9:00 a.m. M-F to schedule a final inspection when completed.
- All repair permits require a \$100 inspection fee paid prior to the final inspection.
- Inspection requests for repairs must be applied for online at: <https://tdec.tn.gov/septic>
- No system shall be covered without the inspection and authorization of the Commissioner. Rule 0400-48-01-.07 (5)
- Homeowners wishing to install their own system must contact Environmental Scientist prior to beginning construction. Testing may be required.
- The excavation of a basement may void this permit if not indicated on the application or may reduce the number of bedrooms for which a permit may be issued.
- Any change in the dwelling location subsequent to the date of permit issuance may void the permit or possibly reduce the number of bedrooms approved or render the lot unusable. **Contact this office before altering dwelling location.**
- The septic tank size and manufacturer must be visible when the final inspection is made.
- **Install the septic tank:**
 - 10ft from water line and other utilities.
 - 5ft from the foundation unless there is a basement.
 - 15ft from cut banks (greater than 18inches high) (basement), natural drains and man-made drains.
 - 50ft from any well.
- Any unauthorized cutting/filling of the area where the field lines will be installed may void this permit or may reduce the number of bedrooms approved on the permit.
- Stay between the **Minimum and Maximum trench depth** as noted on the permit. Measure the trench depth on the down slope side of the trench.
- **Install the field lines:**
 - 10ft from water line, structure and other utilities.
 - 25ft from cut banks (greater than 18inches high) (basement), natural drains and man-made drains.
 - 50ft from any well.

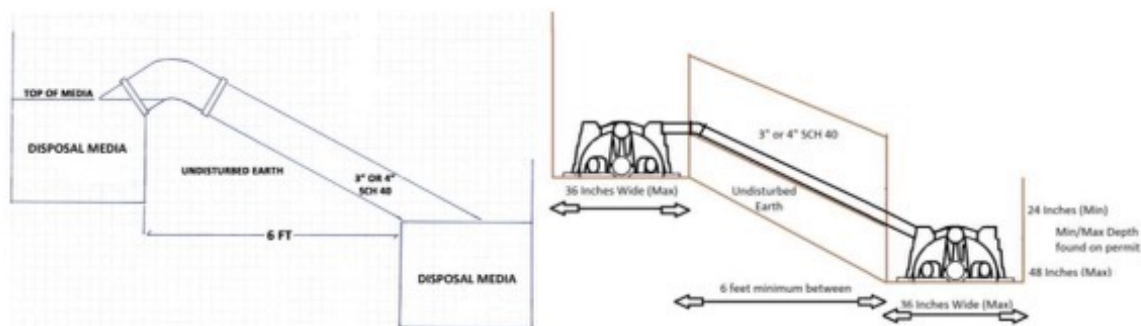

- Use the diagram shown above as a guide to construct the crossovers.
- The size of a chamber system shall be equivalent to the total linear footage required for a three (3) feet wide conventional subsurface sewage disposal system. However, where the soil absorption rate is from **ten (10) to sixty (60) minutes per inch**, the **total linear footage may be reduced by thirty (30) percent**. If a portion of a unit is left over after determining the total linear footage required, round up to the nearest whole unit.
- **If questions arise, please contact the Environmental Scientist at (423)854-5400.**

Tennessee Department of Environment and Conservation

Field and Activity Report Division of Ground Water Protection

County Johnson City Butler Date 3/19/24

Environment Officials Contacted JK Perkins and Jackson Wise

Other Individuals Contacted

Report (1. Purpose of Visit, 2. Activities, 3. Recommendations, 4. Comments)

I evaluated 2 soil pits dug on the property located at 151 Windy Hill Drive in Johnson County. Mr. Derrick Cox owns the property. He advised he was only wanting a 2-bedroom system. His application shows a 3-bedroom request. I advised him to contact environmentalist for the county. The soils were loamy. Depth to CR ranged from 40 to greater than 48 inches. My recommendation is soils be rated 60 mpi to 30 inches.

TDEC
Billy Roach
Soils Consultant Supervisor

(y) Water lines shall not cross, pass through, or go under the subsurface sewage disposal field. Water lines may cross, but not be located in the same trench with, a tight line leading from a septic tank or dosing tank to a disposal field provided the water line is sleeved in a continuous twenty (20) feet section of Schedule 40 PVC pipe or equivalent (a minimum of ten (10) feet on either side of the tight line) and the water line is a minimum of one (1) foot vertically above the tight line.